

DK Series CENTRIFUGAL PUMP

DK series centrifugal pumps are single stage, high efficient electric pumps, consisted of a miniature motor and a single impeller centrifugal pump. They have a good performance in Big Capacity and High Head. They are widely used in well-pumping, water supplying, decanting, mixing and irrigating for civil, industry and agriculture, etc.



CONSTRUCT:

PUMP Peripheral

Pump Body: Cast Iron
Impeller: Brass / Cast Iron
Mechanical Seal: Carbon / Ceramic / Stainless steel

MOTOR Single Phase Heavy Duty Continuous Work

Motor Housing: Aluminium
Shaft: Carbon Steel / Stainless Steel
Insulation: Class B / Class F
Protection: IP44 / IP54
Cooling: External ventilation

1.5DK-20

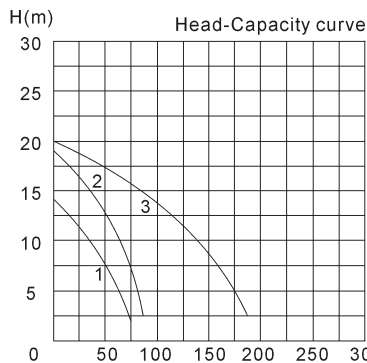

1. 1DK-14
2. 1DK-20
3. 1.5DK-20

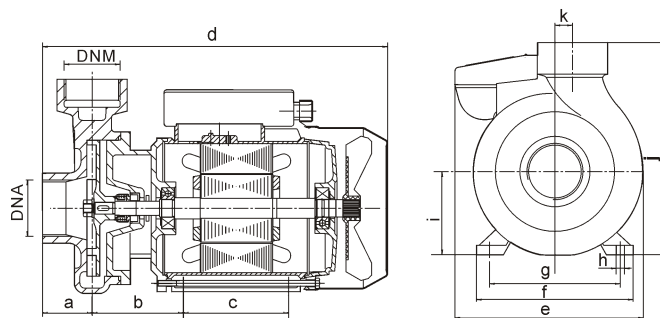

OVERALL & INSTALLATION DIMENSIONS

Model	DIMENSIONS (mm)														
	DNA	DNM	a	b	c	d	e	f	g	h	i	j	k	l	m
1DK-14	1"	1"	44	77	80	260	148	118	100	10	63	173	--	--	--
1DK-20	1"	1"	44	78	90	298	168	136	112	10	71	191	--	--	--
1.5DK-20	1.5"	1.5"	43	78	90	298	168	136	112	10	71	191	--	--	--

PERFORMANCE SPECIFICATIONS

Model	Power		Q.max. L/min	H.max. m	Suct.max. m	Speed r.p.m	Inlet/Outlet mm	PACKAGE DIMENSIONS & G.W.			
	HP	kW						A	B	H	kg
1DK-14	0.40	0.30	75	14			25x25	280	165	185	7.4
1DK-20	0.75	0.55	90	18	9	2850	25x25	325	180	210	11.2
1.5DK-20	1	0.75	180	20			40x40	325	180	210	13.0

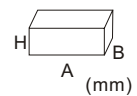

* 110V, 110V/220V, 60Hz etc. models are available on request.